

Old Yeomanry House, 27, Wallingford Street, Wantage, Oxfordshire, OX12 8AU

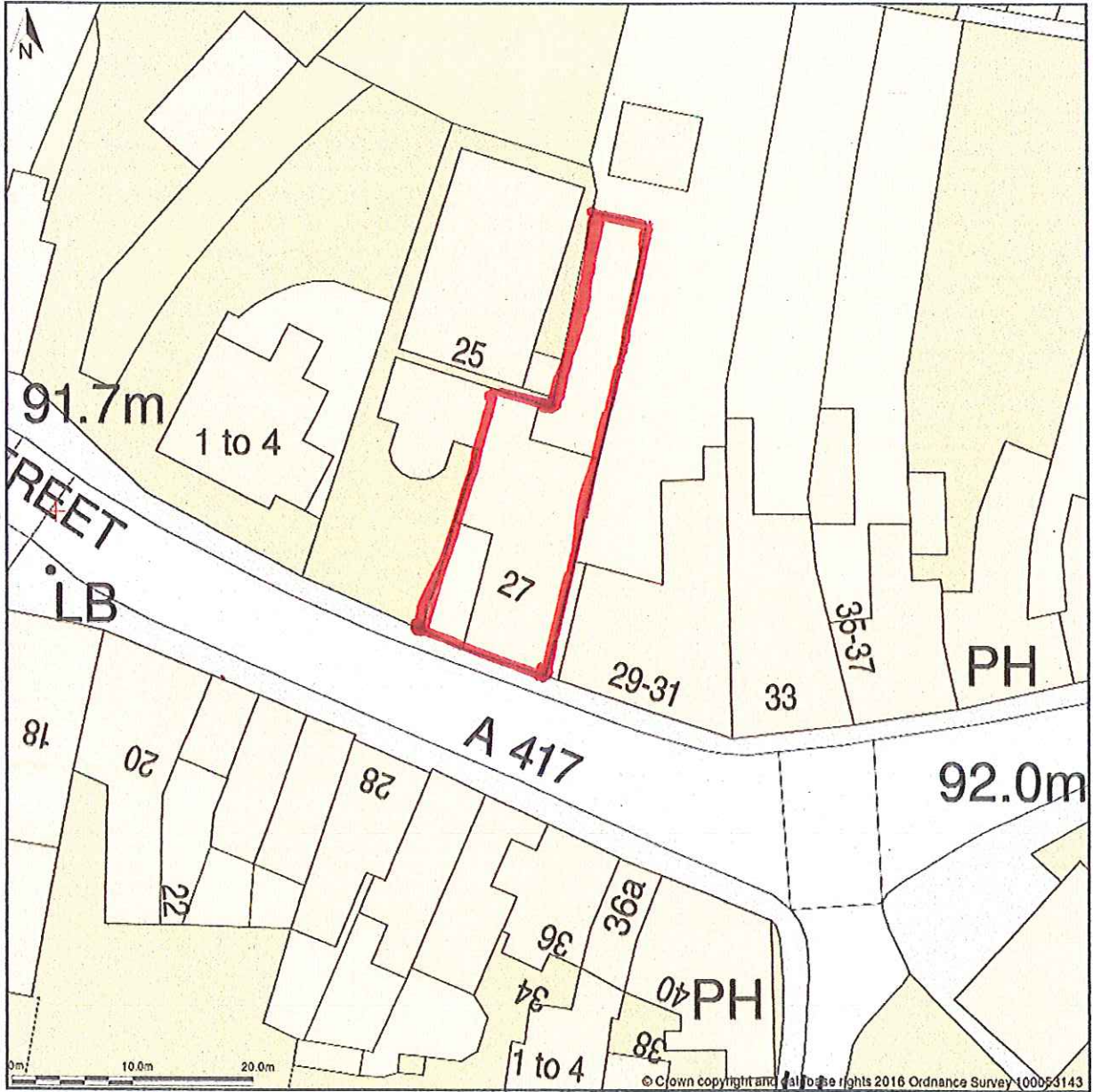

Block Plan shows area bounded by: 439984.78, 187845.4 440054.78, 187935.4 (at a scale of 1:500) The representation of a road, track or path is no evidence of a right of way. The representation of features as lines is no evidence of a property boundary.

Produced on 29th Jul 2016 from the Ordnance Survey National Geographic Database and incorporating surveyed revision available at this data. Reproduction in whole or part is prohibited without the prior permission of Ordnance Survey. © Crown copyright 2016. Supplied by [www.buyaplan.co.uk](http://www.buyaplan.co.uk) a licensed Ordnance Survey partner (100053143). Unique plan reference: #00145894-438D75

Ordnance Survey and the OS Symbol are registered trademarks of Ordnance Survey, the national mapping agency of Great Britain. Buy A Plan logo, pdf design and the [www.buyaplan.co.uk](http://www.buyaplan.co.uk) website are Copyright © Pass Inc Ltd 2016